



Process sensors

# Maintenance-free level detection where other systems fail



Level sensors



**Most reliable deposit suppression on the market**

**Plug and play setup with factory media settings for water or oil**

**Embedded digital communication for enhanced functionality**

**Compact 316SS housing with IP69K environmental protection**

**Robust electronics with high shock and vibration resistance**

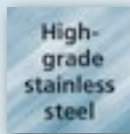
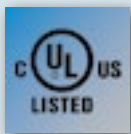

## Reliable level control

The LMC family reliably monitors level in a variety of industrial applications including machine tools, wastewater management, hydraulic systems, and pump run dry protection. Additionally, the back thread option provides a top-mount level solution for custom depths.

## Versatile sensor for all media types

The LMC sensor can be set to detect almost any liquid or viscous media as well as bulk materials. Permanent media temperatures up to 212 °F (100 °C) or heavy adhesion are no problem for the LMC.

Identifying two different types of media is possible due to the two programmable switching outputs. Parameters can be set for each output independently with IO-Link software and USB cable accessory, Part No. E30396.



Process Connection	Insertion Length (mm)	Factory Default Media Setting	Programmable	Medium Temperature (°F)	Part No.	List Price
<b>M12 connector · N.O. / N.C. complementary</b>						
G 1/2 BSPP	12	Water-based	Yes	-13...212	<b>LMC100</b>	<b>\$145.00</b>
G 1/2 BSPP	12	Oil-based	Yes	-13...212	<b>LMC110</b>	<b>\$145.00</b>
G 1/2 BSPP Thread at the back	21	Water-based	Yes	-13...212	<b>LMC400</b>	<b>\$145.00</b>
G 1/2 BSPP Thread at the back	21	Oil-based	Yes	-13...212	<b>LMC410</b>	<b>\$145.00</b>
1/2" NPT	34	Water-based	Yes	-13...212	<b>LMC500</b>	<b>\$145.00</b>
1/2" NPT	34	Oil-based	Yes	-13...212	<b>LMC510</b>	<b>\$145.00</b>
1/2" NPT	40	Water-based	Yes	-13...185	<b>LMC502</b>	<b>\$207.00</b>

**Dimensions**

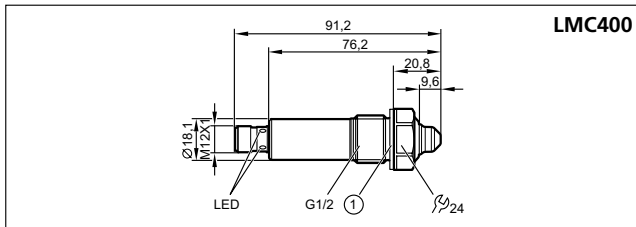
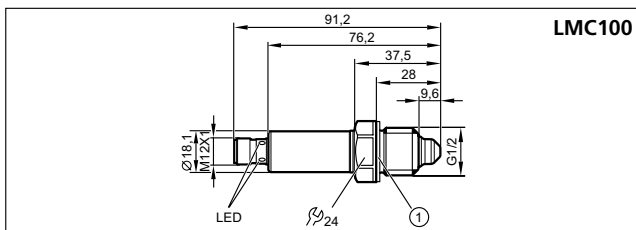

1) Sealing

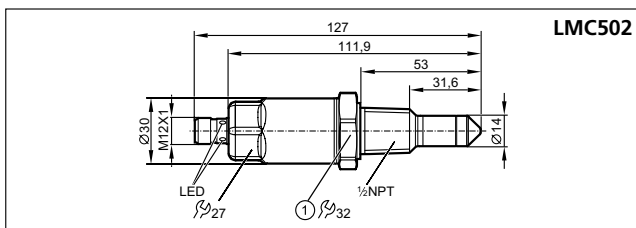
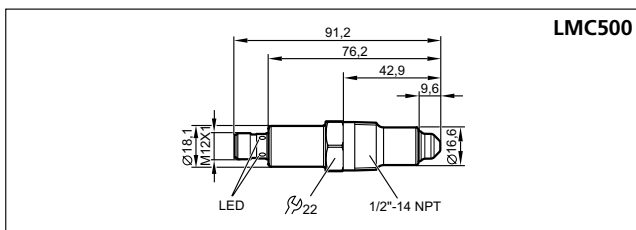

1) tightening torque 50 Nm

Distributed by:



Relevant Solutions | 888.858.3647 | relevantsolutions.com

**Accessories**

Type	Description	Part No.	List Price
	Welding adapter, G 1/2, Ø 26.4 mm	<b>E43375</b>	<b>\$12.00</b>
	Flat seal, 26.5 x 21.3 x 1.5 mm	<b>E43376</b>	<b>\$4.00</b>
	LR DEVICE (supplied on USB flash drive) Software for online and offline parameter setting	<b>QA0011</b>	<b>\$110.00</b>
	USB IO-Link master cable for parameter setting	<b>E30396</b>	<b>\$144.00</b>
	Memory plug to store sensor's parameters for easy upload without a computer	<b>E30398</b>	<b>\$51.00</b>

**Cordsets**

Type	Description	Part No.	List Price
	M12 Micro DC (4-pin) 2 m, PUR	<b>EVC001</b>	<b>\$9.95</b>
	M12 Micro DC (4-pin) 5 m, PUR	<b>EVC002</b>	<b>\$13.50</b>
	M12 Micro DC (4-pin) 2 m, PUR	<b>EVC004</b>	<b>\$9.95</b>
	M12 Micro DC (4-pin) 5 m, PUR	<b>EVC005</b>	<b>\$13.50</b>

**Technical Specs**

Operating Voltage:	18...30 V DC
Current Rating:	100 mA
Housing materials:	316L stainless steel
Materials wetted parts:	PEEK, 316L stainless steel, FPM: LMC502
Protection:	IP 68 / IP 69K
Shock resistance:	50 g
Vibration resistance:	20 g
Ambient temp:	-13...185 °F
Pressure rating:	-14.5...580 psi